

PureFX®



Recessed

6"x4'

1 T5HO

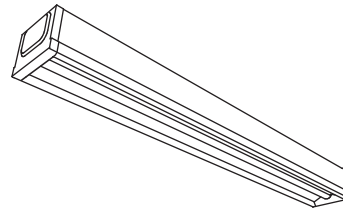

Project Name

Spec Type

Notes

Order Guide

Some combinations of product options may not be available. Consult factory for assistance with your specification.

9464			H154	-		-		-		-	
Product Series & Size	Version	Configuration	Lamping	Housing	Wiring	Voltage	Ballast				
PureFX 6"x4'	D1 Standard T-Grid	ST Standalone CR Continuous Row SMS Standalone Master/Satellite CMS Continuous Row Master/Satellite	1 T5HO (54W)	S Standard (22ga.) T Standard w/ Frame Restraint	1 1 cct 5 1 cct w/ Battery Pack 7 1 cct Dimming	1 120V 2 277V 3 347V	E Standard Ballast				
	See details on next page				Consult website for complete list of standard wiring options		Consult website for ballast manufacturer information				

Upgrades & Accessories

Please indicate with check mark.

<input type="checkbox"/> Lamps Included	<input type="checkbox"/> Lamps Included & Installed
<input type="checkbox"/> Job Pack	
<input type="checkbox"/> Drywall Kit	<p>Can be mounted to wood frame or with hanger wire</p>

Cross Section

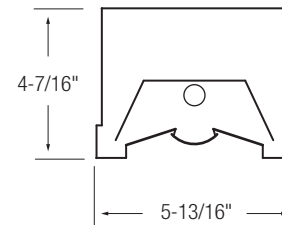

Side View

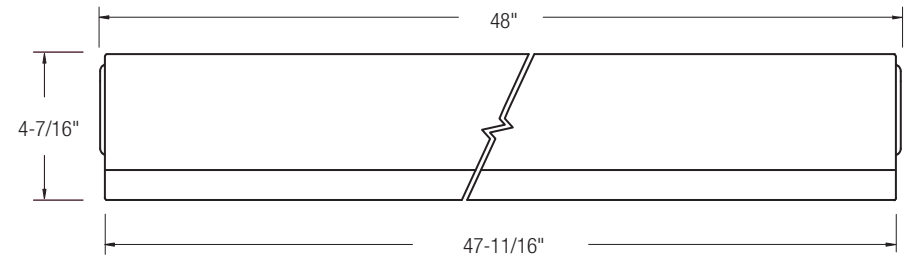

PureFX®

Recessed

6"x4"

1 T5HO

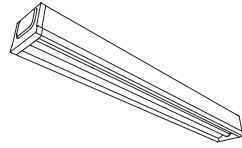

Photometry

Report Summary

Report # 9900026
Filename 9464D1H154.ies
Efficiency 62%

Spacing Criteria 1.2 @ 0° along
 1 @ 90° across

Meets RP-1-04 recommendations for VDT-Normal spaces

Candela Distribution

Vertical Angle	Horizontal Angle					Zonal Lumens
	0	22.5	45	67.5	90	
0	1435	1435	1435	1435	1435	136
5	1426	1424	1422	1418	1419	371
15	1367	1352	1322	1291	1284	516
25	1245	1190	1109	1051	1037	556
35	1045	954	863	815	807	512
45	771	704	643	615	613	402
55	484	469	445	428	418	251
65	253	268	262	234	231	115
75	89	118	109	103	104	26
85	10	20	24	21	23	
90	0	0	0	0	0	

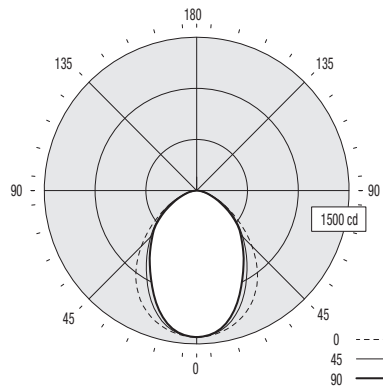

Coefficients of Utilization (%)

Ceiling: Wall:	80				70				50				0			
	70	50	30	10	70	50	30	10	70	50	30	10	70	50	30	10
0 RCR	73	73	73	73	72	72	72	69	69	69	69	62	62	62	62	62
1	68	65	63	61	66	64	62	61	60	58	54	54	54	54	54	54
2	63	58	54	51	61	57	53	55	52	49	46	46	46	46	46	46
3	58	52	47	44	56	51	47	49	45	42	40	40	40	40	40	40
4	53	46	41	38	52	46	41	44	40	37	35	35	35	35	35	35
5	49	42	37	33	48	41	36	40	36	32	30	30	30	30	30	30
6	46	38	33	29	44	37	32	36	32	29	27	27	27	27	27	27
7	42	35	30	26	41	34	29	33	29	26	24	24	24	24	24	24
8	40	32	27	23	39	31	27	31	26	23	22	22	22	22	22	22
9	37	29	24	21	36	29	24	28	24	21	20	20	20	20	20	20
10	35	27	22	19	34	27	22	26	22	19	18	18	18	18	18	18

Based on a floor reflectance of 0.2

Avg. Luminance (cd/m²)

Vertical Angle	Horizontal Angle		
	0	45	90
55	7184	6605	6204
65	5096	5278	4653
75	2927	3585	3421
85	977	2344	2247

IES files for this and other photometric options can be downloaded online at www.ledalite.com

Additional Information

Mounting

Integrates with most common T-bar ceiling types.

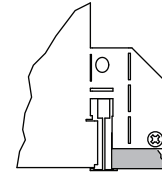

D1 Standard T-Grid

Option D1 works with 9/16" and 15/16" flat T-grid ceilings. It can also be used with slot T-grid ceilings, but it will not sit flush with the bottom of the T-bar.

Ceiling Types

Integrated mounting tabs can be field-adjusted to various T-bar ceiling heights for fastening directly to the T-bar grid and/or tied-off to the building structure.

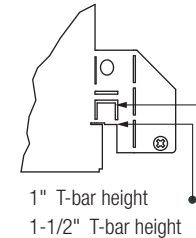

1" T-bar height

1-1/2" T-bar height

Specifications

Due to continuing product improvements, Ledalite reserves the right to change specifications without notice.

Housing

Die-formed, post-painted, 22 gauge cold-rolled steel (New York City version is 20 gauge). Wire entrances are positioned on the side of the housing to allow easy wiring access for the installer. Multiple wire entrances are available on top or side to allow continuous row mounting of fixtures. Optional frame restraint is available to provide additional support to the optical frame.

Weight

Maximum 18 lbs.

Optical System

Optical assembly consists of flat acrylic panels and extruded curved acrylic lens. A protected MesoOptics® film layer creates optimal light distribution and high efficiency. The optical frame ends are constructed from die-formed cold-rolled steel assembled together with extruded aluminum profiles in a sturdy frame. The frame is hinged to allow easy access to the inside of the fixture. Maintenance can be performed from below the ceiling without tools. No hardware is visible.

Mounting

Fixture is compatible with most ceiling types. Integrated bend-out tabs are provided for different T-grid heights. Optional drywall kit is available for non-accessible ceilings. Use screws or hanger wire (supplied by others) to secure fixture.

Ballast

Electronic. Supplied with pre-installed ballast disconnects as per national electric codes.

Wiring

Optional flex whips are supplied in 6' lengths for 1x4, 2x2 and 2x4 fixtures. Flex connectors are supplied in 9' lengths for standard master/satellite configurations.

Air Return

Air return option available in 2'x2' and 2'x4' sizes only. Side rails are finished in black.

Approvals

Certified to UL & CSA Standards.
 City of Chicago Approved CCEA (housing option C).
 Designed to comply with NYC code requirements (Housing Option N).

Finish

Housing and Frame: Post-painted, high quality powder coat. Available in white only.