



Linear

FloatPlane Wall LED

Asymmetric
CRI >80 4000K, 4200 lm/4ft



Project: _____
Spec Type: _____
Catalog No: 24x8LACAG
Qty _____
Line Notes: _____

Interior spaces should resonate, evoke emotion and satisfy a purpose. With FloatPlane LED, it's easier than ever to integrate sleek and sporty style into your layout and within your budget. Fresh and playful with two profile options, Curve and Edge, FloatPlane's performance rivals that of high-end LED luminaires with the affordability of fluorescent.

Ordering guide

Product Type	Version	Source	Color Temp *	Lumens *	Lower Optics	Upper Optics	Run Length	Wiring †	Voltage	Driver	Finish
24		L	A	C	A	G					
24 FloatPlane	G8 Edge Wall R8 Curve Wall	L LED	A 4000K B 3500K C 3000K	C 4200 lm/4ft E 3100 lm/4ft G 2200 lm/4ft	A Acrylic diffuser	A Acrylic diffuser G 75% Down Kit J 100% Down Kit	O4 4' O6 6' O8 8' XX Total run length (2' increments)	1 1 cct 3 1 cct w/ EM cct 5 1 cct w/ BP 7 1 cct w/ Dimming 8 1 cct w/ TW B 2 cct A/B N 1 cct w/ Dim & BP	1 120V 2 277V 3 347V	E Philips Advance Other drivers available - consult factory	W Standard White T Titanium Silver B Black C Custom

* Nominal values within a range. Consult ies file for exact color temp, lumens and up/down distribution † Consult website for complete list of standard wiring options

Mounting Hardware

Wall **Mount Type**
Consult separate mounting spec sheet for mount type options

Endcaps - Edge/Curve

Integrated Controls Please indicate with check mark.

No Options Available

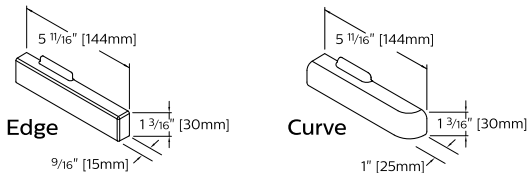

FloatPlane Wall LED

CRI >80 4000K, 4200 lm/4ft

Housing

Precision formed 18 gauge cold-rolled steel. Approx. cross section size: 1.5" h x 8" w (suspended) or 5.7" w (wall mount).

Weight

Maximum: Suspended 3.5lb/ft, Wall 3.3lb/ft

Optical System

White light emitted from dual linear arrays of lateral-facing LEDs is diffused and redirected into the upper and lower hemispheres through a combination of high reflectivity components and acrylic diffusers. This delivers a high efficiency 70% up / 30% down indirect/direct distribution with a wide, homogeneous batwing distribution in the upper hemisphere. Twin polymer diffusers on the lower surface with a combined optical aperture of 5-1/2" deliver a uniform, controlled brightness to maximize visual comfort and luminaire efficacy. Factory or field installable variable optics kits are available to modify the distribution to 75% down or close to 100% down light.

Standard Driver

Philips Advance Xitanium. Output is Class 2 rated. Dimming: 0-10V, 5-100%.

Electrical

Pre-wired to module ends, quick-wire connectors included.

Mounting

Suspended: Rapid installation sling mount at joints and ends. High strength aircraft cable and stainless steel gripper provide unlimited vertical adjustment and are independently tested to meet stringent safety requirements.

Wall: A hidden steel rail and bracket system attaches to the existing structure and supports housings close to the wall. Mount positioning is fully variable along the modules to accommodate site conditions, but should be no more than 4-1/2" on center and always within 12" of an end or joint.

Joints

Self-aligning, gasketed joining system. Access panels in the driver channel allow quick and hassle-free wiring of modules either before or after mechanical joints are completed.

Endcaps

Diecast aluminum endcaps in either Edge or Curve versions to match housing.

Finish

High quality powder coated, available in matte white, black or titanium silver. Other custom colors, including Pacific Aqua and Surf Yellow, available on request.

Approvals

Certified to UL, CSA and IES standards.

Lumen Maintenance

Lumen maintenance of the LEDs has been tested by the manufacturer in accordance with IESNA LM-80-08. At an ambient temperature of 25°C, the LED lumen maintenance expectation is:

Suspended: L₈₀ (12k) 70,000 hrs

Wall mount: L₈₀ (12k) 64,000 hrs

according to IES TM-21-11 Addendum A Reported methodology

Warranty

Philips indoor professional luminaires 5 year LED warranty:

<http://www.philips.com/warranties>

Environment

Rated for dry or damp locations in operating ambient temperatures 0-40°C (32-104°F). Certain luminaire components may be adversely affected by contaminants. Damage caused by sulfur, chlorine, petroleum based solutions or other contaminants in the area of operation are not covered under warranty. Not suitable for natatorium environments.

Due to continuing product improvements, Philips Ledalite reserves the right to change the specifications without notice.

Options and Details

Cross Section

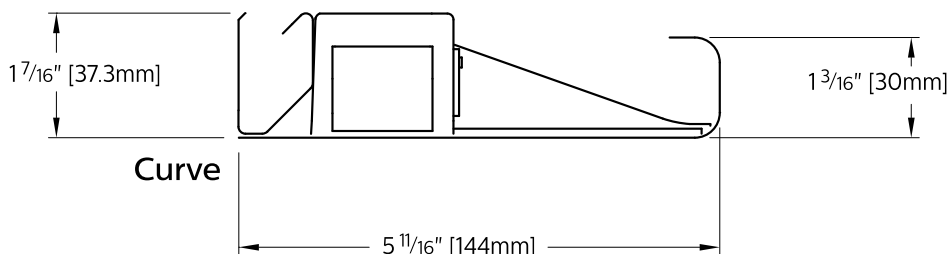
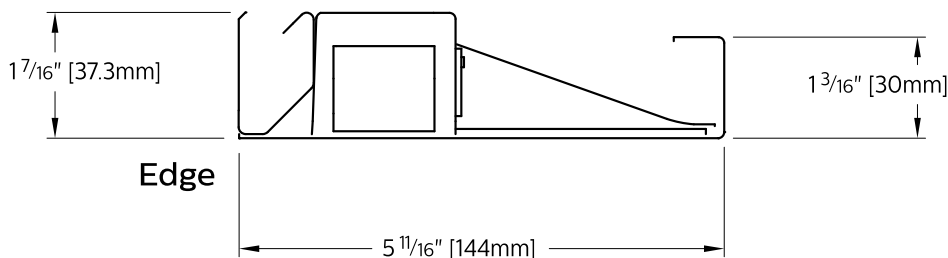

FloatPlane Wall LED

CRI >80 4000K, 4200 lm/4ft

Modules - Edge

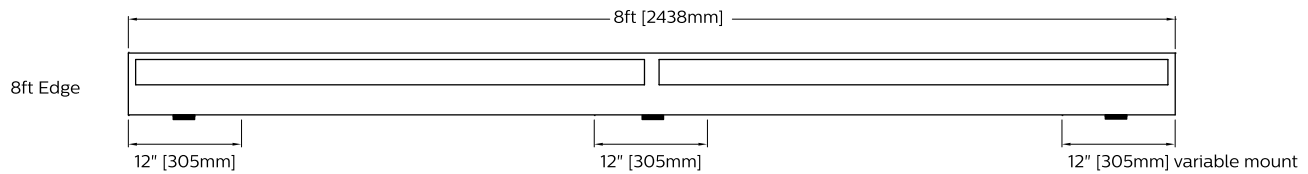
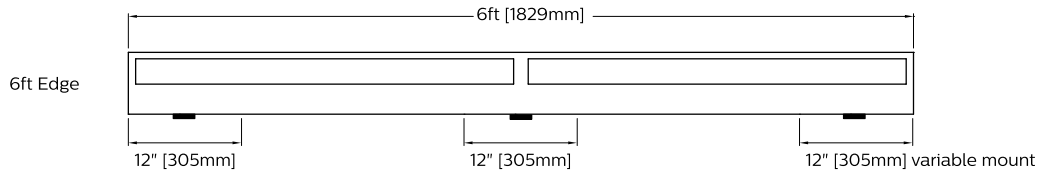
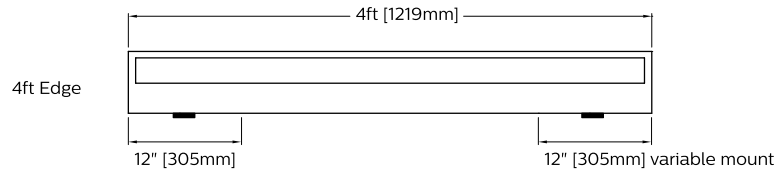

Modules - Curve

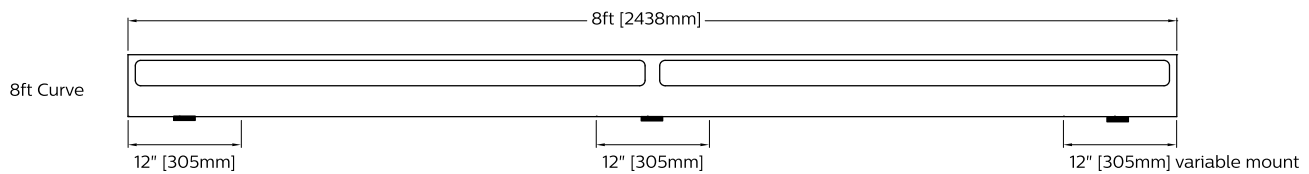
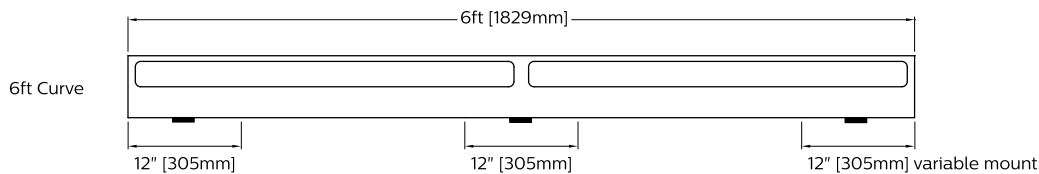
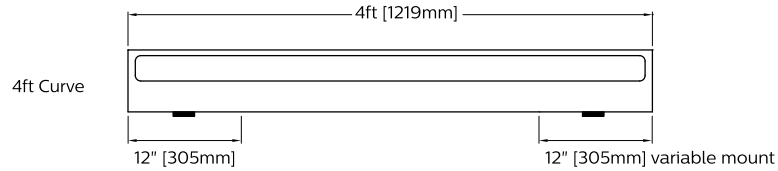

FloatPlane Wall LED

CRI >80 4000K, 4200 lm/4ft

Photometry

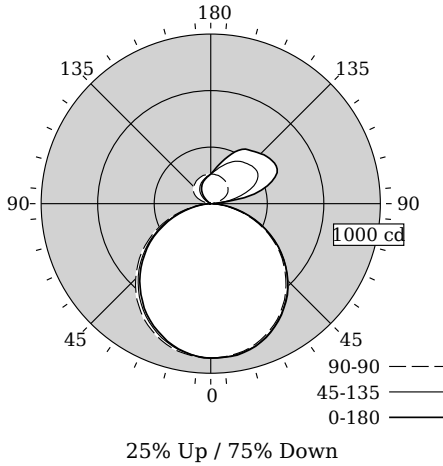

Total Output	3541 lm
Efficacy	94.7 lm/W
CCT	4054K
CRI	83
R9	12
Distribution	25% Up / 75% Down
Spacing Criteria (0/45/180°)	1.30/1.28/1.23

Photometry based on 4ft white luminaire. Black, Titanium and Custom color finishes may reduce delivered lumens. Custom color finishes may shift output color temperature.

Fixture photometry has been conducted by an NVLAP accredited testing laboratory in accordance with IESNA LM-79-08

IES files for this and other photometric options can be downloaded online at www.lightingproducts.philips.com

Candela Distribution

Vertical Angle	Horizontal Angle					Zonal Lumens
	0	45	90	135	180	
0	910	910	910	910	910	0
5	908	910	907	903	905	86
15	891	887	881	870	864	248
25	837	833	823	806	796	377
35	752	750	738	717	701	458
45	643	639	626	604	589	478
55	507	507	496	471	459	436
65	356	356	343	322	308	334
75	196	196	182	165	157	190
85	56	54	41	37	33	52
90	14	10	0	0	0	0
95	37	41	10	2	2	26
105	310	184	45	6	6	102
115	432	294	93	10	10	151
125	442	333	124	46	17	163
135	416	323	141	85	56	152
145	387	304	155	112	93	127
155	337	267	165	134	122	92
165	256	225	172	149	143	53
175	194	188	174	165	163	17
180	174	174	174	174	174	0

Coefficients of Utilization (%)

RCR	Ceiling: Wall										
	70	50	30	10	70	50	30	50	30	10	0
0	113	113	113	113	108	108	108	97	97	97	75
1	103	98	94	91	98	94	90	85	82	80	63
2	94	86	79	74	89	82	76	74	69	65	52
3	85	75	67	61	81	72	65	65	59	55	44
4	78	66	58	51	74	63	56	58	51	46	37
5	72	59	50	44	68	57	49	52	45	40	32
6	66	53	44	38	62	51	43	47	40	35	28
7	61	48	39	34	58	46	38	42	36	31	25
8	57	44	35	30	54	42	34	39	32	27	22
9	53	40	32	27	50	38	31	35	29	24	20
10	49	37	29	24	47	35	28	33	26	22	18

Avg. Luminance (cd/m²)

Vertical Angle	Horizontal Angle		
	0	90	180
55	13051	12752	11805
65	12439	11966	10749
75	11149	10377	8941
85	9507	6884	5573

Philips Ledalite

Light Output (Lumens) 3541

Watts 37.4

Lumens per Watt (Efficacy) 94.68

Color Accuracy 83

Color Rendering Index (CRI)

Light Color 4054 (Bright White)

Correlated Color Temperature (CCT)

2700K 3000K 4500K 6500K

Warm White Bright White Daylight

All results are according to IESNA LM-79-2008: Approved Method for the Electrical and Photometric Testing of Solid-State Lighting. The U.S. Department of Energy (DOE) verifies product test data and results.

Visit www.lightingfacts.com for the Label Reference Guide.

Registration Number: F46Z-B8MKBE (7/9/2015)
Model Number: 24x8LACAG
Type: Luminaire - Linear

Electrical Specifications

Input Voltage	120V	277V
Input Power	37.4W	36.7W
Input Current	0.31A	0.14A
Power Factor	0.99	0.98
Total Harm. Distortion	6%	12.9%
Tested values – contact technical support for rated values. Off-state power zero unless certain controls are specified.		

