

# Linear

## FloatPlane Wall LED

Asymmetric  
CRI >80 4000K, 4200 lm/4ft



Project: \_\_\_\_\_  
Spec Type: \_\_\_\_\_  
Catalog No: 24x8LACAA  
Qty \_\_\_\_\_  
Line Notes: \_\_\_\_\_

Interior spaces should resonate, evoke emotion and satisfy a purpose. With FloatPlane LED, it's easier than ever to integrate sleek and sporty style into your layout and within your budget. Fresh and playful with two profile options, Curve and Edge, FloatPlane's performance rivals that of high-end LED luminaires with the affordability of fluorescent.

### Ordering guide

Product Type	Version	Source	Color Temp *	Lumens *	Lower Optics	Upper Optics	Run Length	Wiring †	Voltage	Driver	Finish
24		L	A	C	A	A					
24 FloatPlane	G8 Edge Wall R8 Curve Wall	L LED	A 4000K B 3500K C 3000K	C 4200 lm/4ft E 3100 lm/4ft G 2200 lm/4ft	A Acrylic diffuser	A Acrylic diffuser G 75% Down Kit J 100% Down Kit	O4 4' O6 6' O8 8' XX Total run length (2' increments)	1 1 cct 3 1 cct w/ EM cct 5 1 cct w/ BP 7 1 cct w/ Dimming 8 1 cct w/ TW B 2 cct A/B N 1 cct w/ Dim & BP	1 120V 2 277V 3 347V	E Philips Advance  Other drivers available - consult factory	W Standard White T Titanium Silver B Black C Custom

\* Nominal values within a range. Consult ies file for exact color temp, lumens and up/down distribution † Consult website for complete list of standard wiring options

### Mounting Hardware

Wall **Mount Type**  
Consult separate mounting spec sheet for mount type options

Endcaps -  Edge/Curve

**Integrated Controls** Please indicate with check mark.

No Options Available

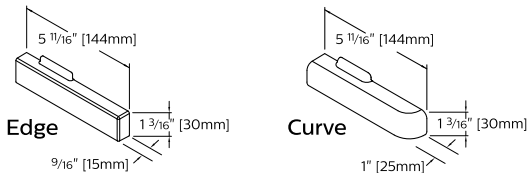

# FloatPlane Wall LED

CRI >80 4000K, 4200 lm/4ft

## Housing

Precision formed 18 gauge cold-rolled steel. Approx. cross section size: 1.5" h x 8" w (suspended) or 5.7" w (wall mount).

## Weight

Maximum: Suspended 3.5lb/ft, Wall 3.3lb/ft

## Optical System

White light emitted from dual linear arrays of lateral-facing LEDs is diffused and redirected into the upper and lower hemispheres through a combination of high reflectivity components and acrylic diffusers. This delivers a high efficiency 70% up / 30% down indirect/direct distribution with a wide, homogeneous batwing distribution in the upper hemisphere. Twin polymer diffusers on the lower surface with a combined optical aperture of 5-1/2" deliver a uniform, controlled brightness to maximize visual comfort and luminaire efficacy. Factory or field installable variable optics kits are available to modify the distribution to 75% down or close to 100% down light.

## Standard Driver

Philips Advance Xitanium. Output is Class 2 rated. Dimming: 0-10V, 5-100%.

## Electrical

Pre-wired to module ends, quick-wire connectors included.

## Mounting

**Suspended:** Rapid installation sling mount at joints and ends. High strength aircraft cable and stainless steel gripper provide unlimited vertical adjustment and are independently tested to meet stringent safety requirements.

**Wall:** A hidden steel rail and bracket system attaches to the existing structure and supports housings close to the wall. Mount positioning is fully variable along the modules to accommodate site conditions, but should be no more than 4-1/2" on center and always within 12" of an end or joint.

## Joints

Self-aligning, gasketed joining system. Access panels in the driver channel allow quick and hassle-free wiring of modules either before or after mechanical joints are completed.

## Endcaps

Diecast aluminum endcaps in either Edge or Curve versions to match housing.

## Finish

High quality powder coated, available in matte white, black or titanium silver. Other custom colors, including Pacific Aqua and Surf Yellow, available on request.

## Approvals

Certified to UL, CSA and IES standards.

## Lumen Maintenance

Lumen maintenance of the LEDs has been tested by the manufacturer in accordance with IESNA LM-80-08. At an ambient temperature of 25°C, the LED lumen maintenance expectation is:

**Suspended:** L<sub>80</sub> (12k) 70,000 hrs

**Wall mount:** L<sub>80</sub> (12k) 64,000 hrs

according to IES TM-21-11 Addendum A Reported methodology

## Warranty

Philips indoor professional luminaires 5 year LED warranty:

<http://www.philips.com/warranties>

## Environment

Rated for dry or damp locations in operating ambient temperatures 0-40°C (32-104°F). Certain luminaire components may be adversely affected by contaminants. Damage caused by sulfur, chlorine, petroleum based solutions or other contaminants in the area of operation are not covered under warranty. Not suitable for natatorium environments.

Due to continuing product improvements, Philips Ledalite reserves the right to change the specifications without notice.

## Options and Details

### Cross Section

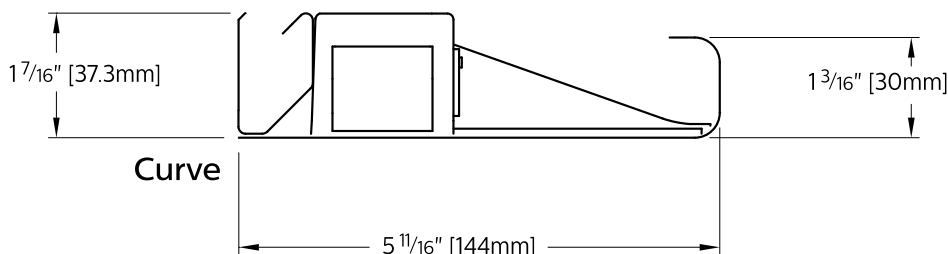
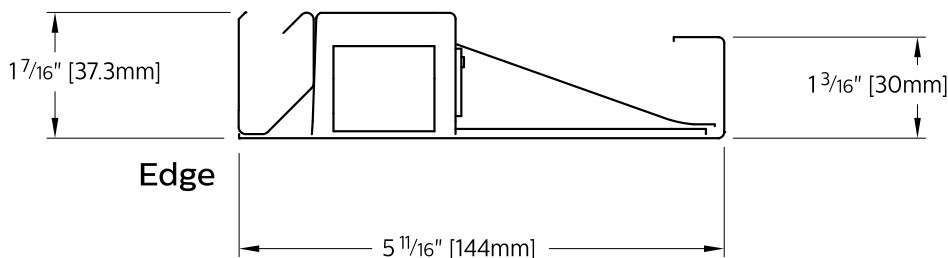

# FloatPlane Wall LED

CRI >80 4000K, 4200 lm/4ft

## Modules - Edge

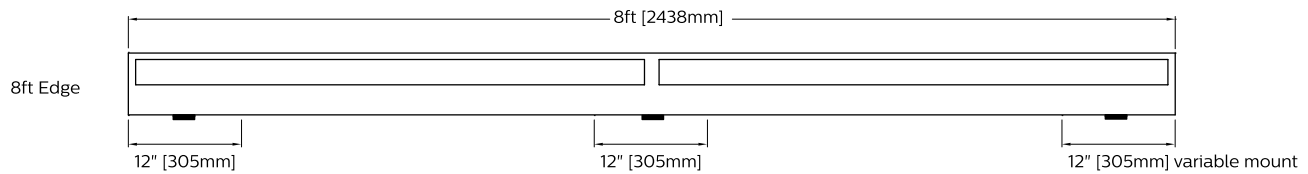
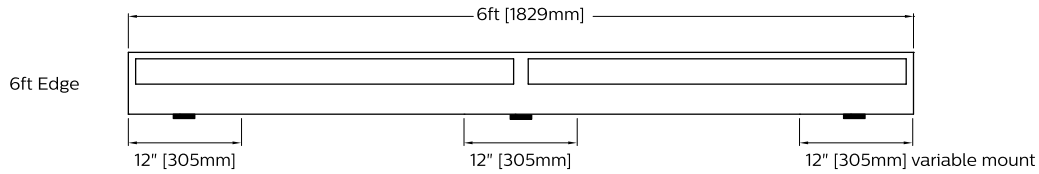
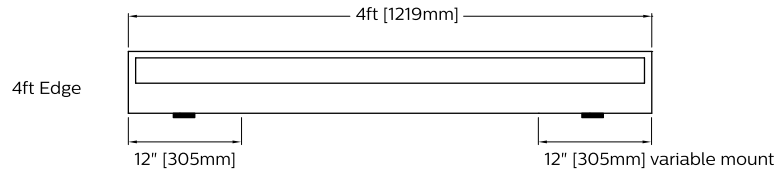

## Modules - Curve

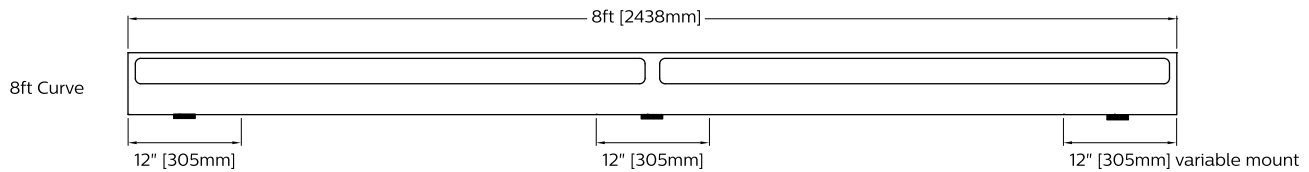
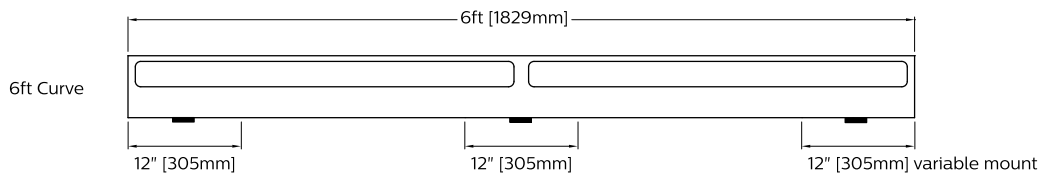
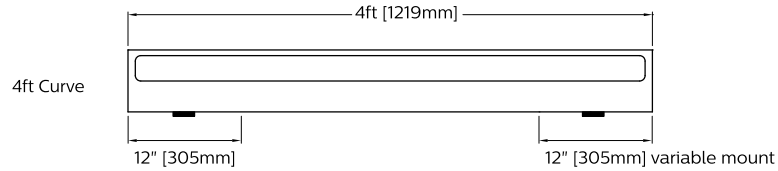

# FloatPlane Wall LED

CRI >80 4000K, 4200 lm/4ft

## Photometry

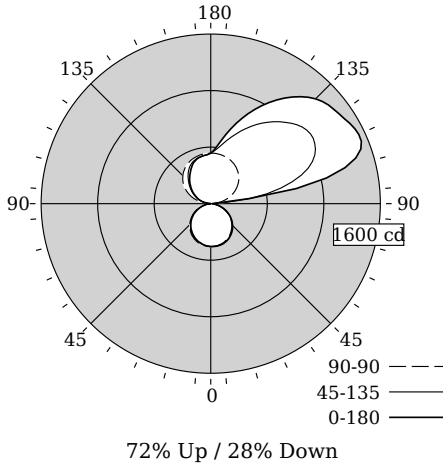

Total Output	4250 lm
Efficacy	113.6 lm/W
CCT	4054K
CRI	83
R9	12
Distribution	72% Up / 28% Down
Peak/Zenith Ratio	3.24
Peak Output	1542 cd @ 115°
Meets RP-1-12 recommendations for VDT-Critical spaces	

Photometry based on 4ft white luminaire. Black, Titanium and Custom color finishes may reduce delivered lumens. Custom color finishes may shift output color temperature.

Fixture photometry has been conducted by an NVLAP accredited testing laboratory in accordance with IESNA LM-79-08

IES files for this and other photometric options can be downloaded online at [www.lightingproducts.philips.com](http://www.lightingproducts.philips.com)

## Candela Distribution

Vertical Angle	Horizontal Angle				Zonal Lumens
	0	45	90	135	
0	405	405	405	405	0
5	405	405	403	401	38
15	399	397	391	385	110
25	378	376	368	358	169
35	341	339	329	320	205
45	291	291	281	271	265
55	231	229	221	213	207
65	161	159	153	147	151
75	87	87	81	76	86
85	23	23	19	17	24
90	15	10	0	0	0
95	45	157	43	10	103
105	1311	794	145	95	89
115	1542	1083	236	159	149
125	1478	1149	312	227	215
135	1399	1073	372	296	279
145	1216	938	418	368	341
155	980	781	449	422	407
165	730	626	467	449	447
175	527	507	477	463	461
180	477	477	477	477	477

## Coefficients of Utilization (%)

RCR	Ceiling/Wall											
	70	50	30	10	70	50	30	50	30	10	0	0
0	102	102	102	102	91	91	91	71	71	71	28	28
1	93	89	85	81	83	79	76	62	60	58	23	23
2	84	77	71	66	75	69	64	54	51	48	19	19
3	77	68	60	55	68	61	55	48	43	40	16	16
4	70	60	52	46	62	54	47	42	37	34	14	14
5	64	53	45	39	57	48	41	38	33	29	12	12
6	59	47	39	34	52	43	36	34	29	25	10	10
7	54	42	35	29	48	38	32	30	25	22	9	9
8	50	38	31	26	45	35	28	28	23	19	8	8
9	47	35	28	23	42	32	25	25	20	17	7	7
10	44	32	25	20	39	29	23	23	18	15	7	7

## Avg. Luminance (cd/m<sup>2</sup>)

Vertical Angle	Horizontal Angle		
	0	90	180
55	5928	5679	5330
65	5611	5341	4935
75	4968	4636	4084
85	3934	3278	2623

Philips Ledalite

**Light Output (Lumens)** **4250**

**Watts** **37.4**

**Lumens per Watt (Efficacy)** **113.64**

---

**Color Accuracy** **83**

Color Rendering Index (CRI)

---

**Light Color** **4054 (Bright White)**

Correlated Color Temperature (CCT)

2700K   3000K   4500K   6500K

All results are according to IESNA LM-79-2008: Approved Method for the Electrical and Photometric Testing of Solid-State Lighting. The U.S. Department of Energy (DOE) verifies product test data and results.

Visit [www.lightingfacts.com](http://www.lightingfacts.com) for the Label Reference Guide.

Registration Number: F46Z-1SRQEM (7/9/2015)  
Model Number: 24x8LACAA  
Type: Luminaire - Linear

## Electrical Specifications

<b>Input Voltage</b>	<b>120V</b>	<b>277V</b>
<b>Input Power</b>	<b>37.4W</b>	<b>36.7W</b>
<b>Input Current</b>	<b>0.31A</b>	<b>0.14A</b>
<b>Power Factor</b>	<b>0.99</b>	<b>0.98</b>
<b>Total Harm. Distortion</b>	<b>6%</b>	<b>12.9%</b>
Tested values – contact technical support for rated values. Off-state power zero unless certain controls are specified.		

