



# Linear

## FloatPlane Wall LED

Asymmetric  
CRI >80 3500K, 3100 lm/4ft



Project: \_\_\_\_\_  
Spec Type: \_\_\_\_\_  
Catalog No: 24x8LBEAG  
Qty: \_\_\_\_\_  
Line Notes: \_\_\_\_\_

Interior spaces should resonate, evoke emotion and satisfy a purpose. With FloatPlane LED, it's easier than ever to integrate sleek and sporty style into your layout and within your budget. Fresh and playful with two profile options, Curve and Edge, FloatPlane's performance rivals that of high-end LED luminaires with the affordability of fluorescent.

### Ordering guide

Product Type	Version	Source	Color Temp *	Lumens *	Lower Optics	Upper Optics	Run Length	Wiring †	Voltage	Driver	Finish
24		L	B	E	A	G					
24 FloatPlane	G8 Edge Wall R8 Curve Wall	L LED	A 4000K B 3500K C 3000K	C 4200 lm/4ft E 3100 lm/4ft G 2200 lm/4ft	A Acrylic diffuser	A Acrylic diffuser G 75% Down Kit J 100% Down Kit	O4 4' O6 6' O8 8' XX Total run length (2' increments)	1 1 cct 3 1 cct w/ EM cct 5 1 cct w/ BP 7 1 cct w/ Dimming 8 1 cct w/ TW B 2 cct A/B N 1 cct w/ Dim & BP	1 120V 2 277V 3 347V	E Philips Advance  Other drivers available - consult factory	W Standard White T Titanium Silver B Black C Custom

\* Nominal values within a range. Consult ies file for exact color temp, lumens and up/down distribution † Consult website for complete list of standard wiring options

### Mounting Hardware

Wall **Mount Type**  
Consult separate mounting spec sheet for mount type options

Endcaps -  Edge/Curve

**Integrated Controls** Please indicate with check mark.

No Options Available

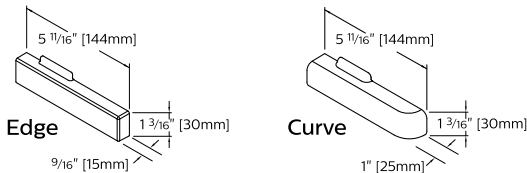

# FloatPlane Wall LED

CRI >80 3500K, 3100 lm/4ft

## Housing

Precision formed 18 gauge cold-rolled steel. Approx. cross section size: 1.5" h x 8" w (suspended) or 5.7" w (wall mount).

## Weight

Maximum: Suspended 3.5lb/ft, Wall 3.3lb/ft

## Optical System

White light emitted from dual linear arrays of lateral-facing LEDs is diffused and redirected into the upper and lower hemispheres through a combination of high reflectivity components and acrylic diffusers. This delivers a high efficiency 70% up / 30% down indirect/direct distribution with a wide, homogeneous batwing distribution in the upper hemisphere. Twin polymer diffusers on the lower surface with a combined optical aperture of 5-1/2" deliver a uniform, controlled brightness to maximize visual comfort and luminaire efficacy. Factory or field installable variable optics kits are available to modify the distribution to 75% down or close to 100% down light.

## Standard Driver

Philips Advance Xitanium. Output is Class 2 rated. Dimming: 0-10V, 5-100%.

## Electrical

Pre-wired to module ends, quick-wire connectors included.

## Mounting

**Suspended:** Rapid installation sling mount at joints and ends. High strength aircraft cable and stainless steel gripper provide unlimited vertical adjustment and are independently tested to meet stringent safety requirements.

**Wall:** A hidden steel rail and bracket system attaches to the existing structure and supports housings close to the wall. Mount positioning is fully variable along the modules to accommodate site conditions, but should be no more than 4-1/2ft on center and always within 12" of an end or joint.

## Joints

Self-aligning, gasketed joining system. Access panels in the driver channel allow quick and hassle-free wiring of modules either before or after mechanical joints are completed.

## Endcaps

Diecast aluminum endcaps in either Edge or Curve versions to match housing.

## Finish

High quality powder coated, available in matte white, black or titanium silver. Other custom colors, including Pacific Aqua and Surf Yellow, available on request.

## Approvals

Certified to UL, CSA and IES standards.

## Lumen Maintenance

Lumen maintenance of the LEDs has been tested by the manufacturer in accordance with IESNA LM-80-08. At an ambient temperature of 25°C, the LED lumen maintenance expectation is:

**Suspended:** L<sub>80</sub> (12k) 70,000 hrs

**Wall mount:** L<sub>80</sub> (12k) 64,000 hrs

according to IES TM-21-11 Addendum A Reported methodology

## Warranty

Philips indoor professional luminaires 5 year LED warranty:

<http://www.philips.com/warranties>

## Environment

Rated for dry or damp locations in operating ambient temperatures 0-40°C (32-104°F). Certain luminaire components may be adversely affected by contaminants. Damage caused by sulfur, chlorine, petroleum based solutions or other contaminants in the area of operation are not covered under warranty. Not suitable for natatorium environments.

Due to continuing product improvements, Philips Ledalite reserves the right to change the specifications without notice.

## Options and Details

### Cross Section

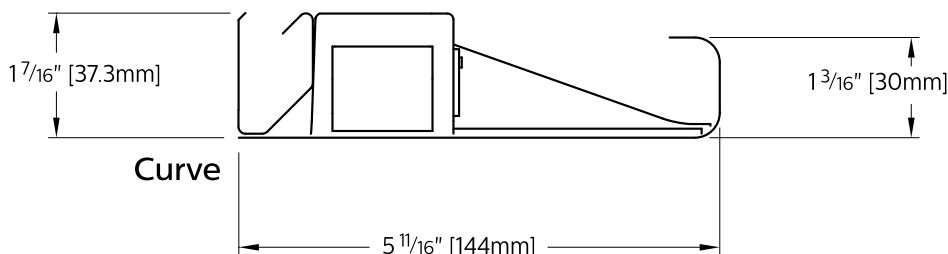
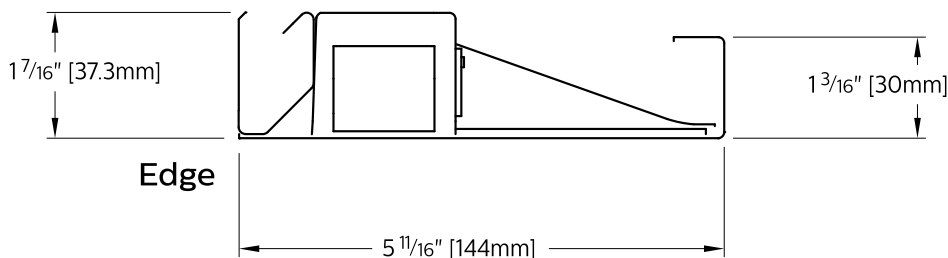

# FloatPlane Wall LED

CRI >80 3500K, 3100 lm/4ft

## Modules - Edge

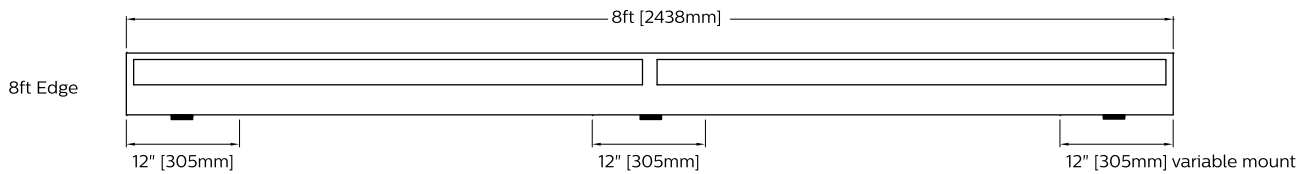
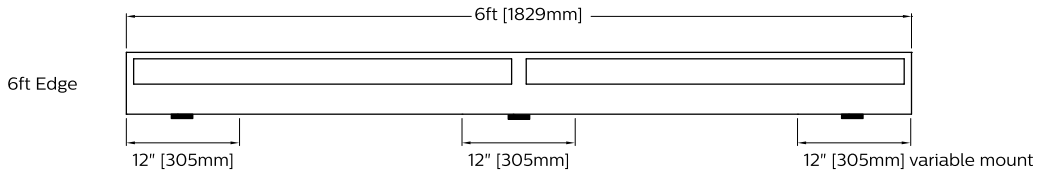
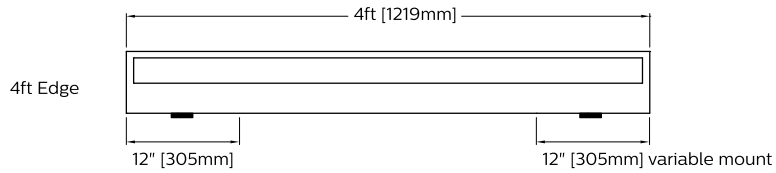

## Modules - Curve

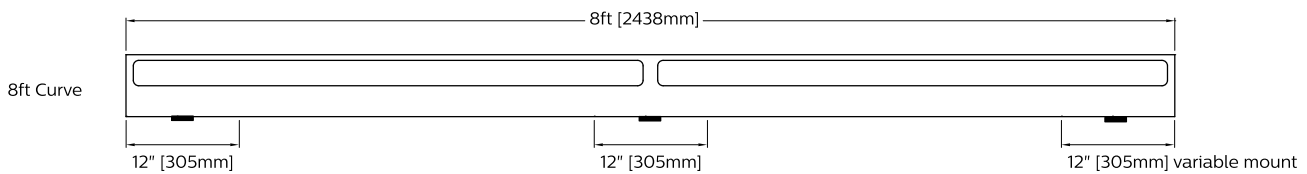
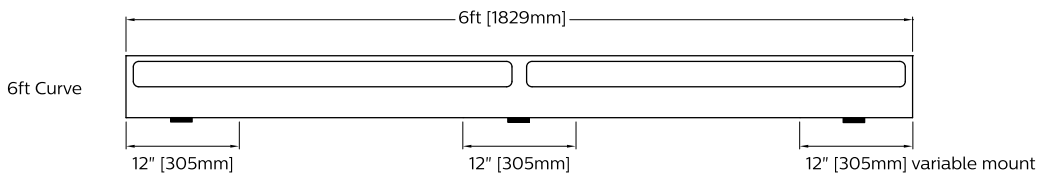
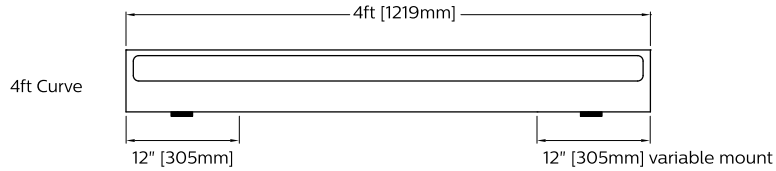

# FloatPlane Wall LED

CRI >80 3500K, 3100 lm/4ft

## Photometry

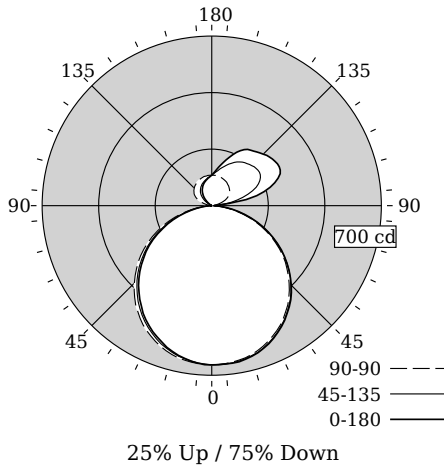

Total Output	2556 lm
Efficacy	98.3 lm/W
CCT	3427K
CRI	82
R9	6
Distribution	25% Up / 75% Down
Spacing Criteria (0/45/180°)	1.30/1.28/1.23
Meets RP-1-12 recommendations for VDT-Normal spaces	

Photometry based on 4ft white luminaire. Black, Titanium and Custom color finishes may reduce delivered lumens. Custom color finishes may shift output color temperature.

Fixture photometry has been conducted by an NVLAP accredited testing laboratory in accordance with IESNA LM-79-08

IES files for this and other photometric options can be downloaded online at [www.lightingproducts.philips.com](http://www.lightingproducts.philips.com)

## Candela Distribution

Vertical Angle	Horizontal Angle				Zonal Lumens
	0	45	90	135	
0	657	657	657	657	0
5	636	657	654	651	62
15	643	640	636	628	179
25	604	601	594	582	272
35	542	541	533	517	330
45	464	461	452	436	345
55	366	366	358	340	315
65	257	257	247	232	241
75	141	141	131	119	113
85	41	39	29	27	24
90	10	7	0	0	0
95	27	29	7	1	19
105	224	133	32	4	73
115	312	212	67	7	109
125	319	240	89	34	118
135	301	233	102	62	110
145	280	219	112	81	92
155	243	193	119	96	66
165	185	162	124	108	38
175	140	136	126	119	12
180	126	126	126	126	0

## Coefficients of Utilization (%)

RCR	Ceiling: Wall											
	80			70			50			0		
	70	50	30	10	70	50	30	10	50	30	10	0
0	113	113	113	113	108	108	108	97	97	97	75	75
1	103	98	94	91	98	94	90	85	82	80	63	63
2	94	86	79	74	89	82	76	74	69	65	52	52
3	85	75	67	61	81	72	65	65	59	55	44	44
4	78	66	58	51	74	63	56	58	51	46	37	37
5	72	59	50	44	68	57	49	52	45	40	32	32
6	66	53	44	38	62	51	43	47	40	35	28	28
7	61	48	39	34	58	46	38	42	36	31	25	25
8	57	44	35	30	54	42	34	39	32	27	22	22
9	53	40	32	27	50	38	31	35	29	24	20	20
10	49	37	29	24	47	35	28	33	26	22	18	18

## Avg. Luminance (cd/m<sup>2</sup>)

Vertical Angle	Horizontal Angle		
	0	90	180
55	9419	9203	8520
65	8978	8636	7758
75	8047	7489	6453
85	6861	4968	4022

Philips Ledalite

**Light Output (Lumens)** **2556**

**Watts** **26**

**Lumens per Watt (Efficacy)** **98.31**

---

**Color Accuracy** **82**

Color Rendering Index (CRI)

---

**Light Color** **3427 (Bright White)**

Correlated Color Temperature (CCT)

2700K    3000K    4500K    6500K

All results are according to IESNA LM-79-2008: Approved Method for the Electrical and Photometric Testing of Solid-State Lighting. The U.S. Department of Energy (DOE) verifies product test data and results.

Visit [www.lightingfacts.com](http://www.lightingfacts.com) for the Label Reference Guide.

Registration Number: F46Z-P2H6D3 (7/9/2015)  
Model Number: 24x8LBEAG  
Type: Luminaire - Linear

## Electrical Specifications

<b>Input Voltage</b>	<b>120V</b>	<b>277V</b>
<b>Input Power</b>	<b>26W</b>	<b>25.8W</b>
<b>Input Current</b>	<b>0.22A</b>	<b>0.1A</b>
<b>Power Factor</b>	<b>0.998</b>	<b>0.959</b>
<b>Total Harm. Distortion</b>	<b>7.2%</b>	<b>14%</b>
Tested values – contact technical support for rated values. Off-state power zero unless certain controls are specified.		

