

# Transforming light into an element of design

## TRUGROOVE STANDALONE PERFORMANCE LED

DIRECT PERFORMANCE, FLUSH MESOOPTICS LENS  
3500K, 3000 LM/4FT

**Project:**

**Spec Type:**

**Catalog No:** 39S1LBEQ

**Qty**

**Line Notes:**

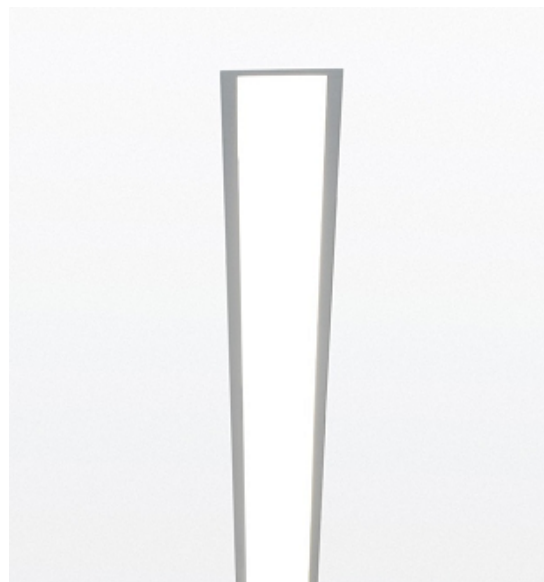

### Ordering guide

Product Type	Source	Color *	Lumens *	Optics	Housing	Ceiling / Trim	Run Length	Wiring †	Voltage	Driver ‡
<input type="text" value="39S1"/>	<input type="text" value="L"/>	<input type="text" value="B"/>	<input type="text" value="E"/>	<input type="text" value="Q"/>	<input type="text" value="S"/>	<input type="text"/>	<input type="text"/>	<input type="text"/>	<input type="text"/>	<input type="text"/>
TruGroove Standalone Performance LED	L LED	A 4000K B 3500K C 3000K	E 3000 lm/4ft G 2200 lm/4ft K 1500 lm/4ft	Q Flush Lens R Regressed Lens	S Standard C Chicago Plenum	1 T-Grid 4 Drywall Trim 3 Drywall Trimless	02' 04' 08'	1 1 cct 3 1 cct w/ EM cct 5 1 cct w/ BP 7 1 cct w/ Dimming	1 120V 2 277V 3 347V	E Standard

\* Nominal values † Consult website for complete list of standard wiring options ‡ Driver details on following pages

### Mounting Hardware

Mount Type  
Consult separate mounting spec sheet for mount type options

**Endcaps** -

**Integrated Controls** Please indicate with check mark.

Response Daylight Single Zone (DS)



# TRUGROOVE STANDALONE PERFORMANCE LED

Direct Performance, Flush MesoOptics Lens

## Photometry

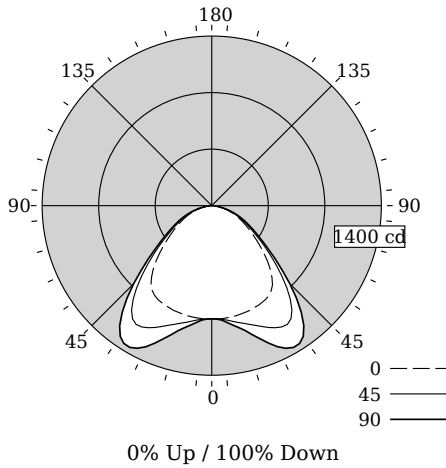

Total Output	3066 lm
Efficacy	74.1 lm/W
CCT	3503K
CRI	83
R9	9
Distribution	0% Up / 100% Down
Spacing Criteria (0/90/180°)	1.41/1.75/NA

Values per 4ft unit

Fixture photometry has been conducted by an NVLAP accredited testing laboratory in accordance with IESNA LM-79:2008

Lumen maintenance of the LEDs has been tested by the manufacturer in accordance with IESNA LM-80:2008

IES files for this and other photometric options can be downloaded online at [www.ledalite.com](http://www.ledalite.com)

## Candela Distribution

Vertical Angle	Horizontal Angle				Zonal Lumens
	0	22.5	45	67.5	
0	934	934	934	934	0
5	937	930	943	951	91
15	926	943	1005	1051	285
25	908	969	1110	1239	510
35	856	945	1140	1275	684
45	653	701	816	892	615
55	413	447	475	501	427
65	252	268	278	294	278
75	123	127	135	145	144
85	22	22	26	28	32
90	0	0	0	0	0
95	0	0	0	0	0
105	0	0	0	0	0
115	0	0	0	0	0
125	0	0	0	0	0
135	0	0	0	0	0
145	0	0	0	0	0
155	0	0	0	0	0
165	0	0	0	0	0
175	0	0	0	0	0
180	0	0	0	0	0

## Coefficients of Utilization (%)

RCR	Ceiling:		80				70				50	
	Wall:	70	50	30	10	70	50	30	50	30	10	
0	119	119	119	119	116	116	116	111	111	111	111	
1	110	105	102	98	107	103	100	99	96	93	93	
2	101	93	87	81	98	91	85	88	83	78	78	
3	92	82	75	68	90	81	74	78	72	67	67	
4	85	73	65	58	82	72	64	69	63	57	57	
5	78	66	57	51	76	65	56	62	55	50	50	
6	72	59	51	44	70	58	50	56	49	44	44	
7	67	54	45	39	65	53	45	51	44	39	39	
8	62	49	41	35	61	48	40	47	40	35	35	
9	58	45	37	31	57	44	37	43	36	31	31	
10	54	41	33	28	53	41	33	40	33	28	28	

## Avg. Luminance (cd/m<sup>2</sup>)

Vertical Angle	Horizontal Angle		
	0	45	90
55	7910	9106	9801
65	6546	7227	7855
75	5216	5729	6157
85	2793	3301	3555

## Electrical Specifications

Input Voltage	120V	277V
Input Power	41.4W	41W
Input Current	0.349A	0.161A
Power Factor	0.988	
Total Harm. Distortion	13.7%	
Tested values – contact technical support for rated values. Off-state power zero unless certain controls are specified.		

## Modules & Runs

TruGroove Standalone LED nominal housing lengths

2ft, 4ft, 8ft

Flush lens trimless versions can be installed in either the wall or ceiling.

Refer to module size details below for actual dimensions e.g. trim. T-grid units fit within a standard 2' grid.  
To specify continuous runs, refer to TruGroove Continuous data sheets.

### Standalone Modules



2 ft



4 ft



8 ft

## Module Dimensions

### Standalone recessed

#### T-Grid

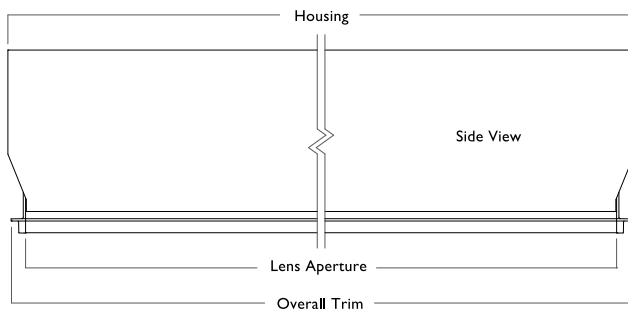

#### Drywall

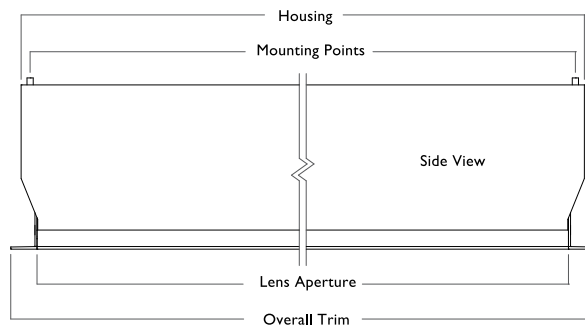

Nominal length	Housing	Lens aperture	Mounting points	Trim – T-Grid	Trim – Drywall Trimless	Trim – Drywall Trim
2ft	23.9"/607 mm	23.0"/584 mm	23.4"/584 mm	23.75"/603 mm	26.35"/669 mm	24.5"/622 mm
4ft	47.9"/1217 mm	47.0"/1194 mm	47.4"/1204 mm	47.75"/1213 mm	50.35"/1279 mm	48.5"/1232 mm
8ft	95.9"/2436 mm	95.0"/2413 mm	95.4"/2423 mm	95.75"/2432 mm	98.35"/2498 mm	96.5"/2451 mm

## Options and Details

### Drywall

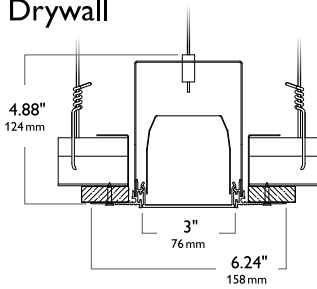

Trimless

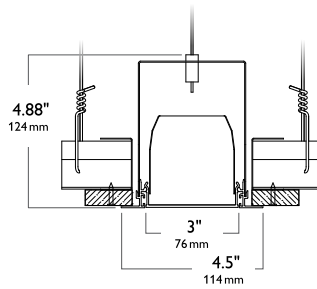

Trim

### T-grid\*

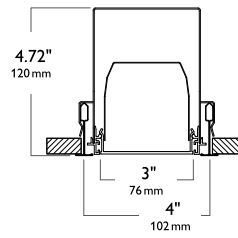

Standard 9/16"  
Standard 15/16"

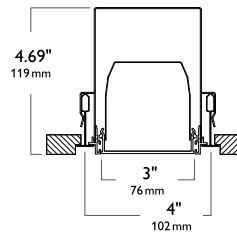

Tegular 9/16"

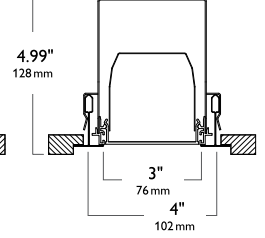

Tegular 15/16"

\* Compatible with TechZone® 4" Ceiling Grid

### Trim Views

#### Flush lens



Drywall Trimless



Drywall Trim



T-grid

### Housing

Die-formed 20 gauge cold-rolled steel. Multiple upper wire entrances available for continuous row mounting of fixtures.

### Weight

Maximum 3.5lb/ft.

### Optical System

Performance version: White light emitted from the LED sources is internally reflected and laterally redirected by a biconvex lens. Light is then reflected by Miro Silver panels and exits through the optical lens assembly. This assembly contains acrylic extrusion profiles to retain a layer of MesoOptics film, creating both an uninterrupted continuum of light and an optical batwing distribution.

Definition version: Light passes through a diffuse white acrylic lens to deliver a highly uniform luminous continuum.

### Standard Driver

Dimming: 0-10V, 5-100%. Output is Class 2 rated.

### Lumen Maintenance

At an ambient temperature of 25°C in non-insulated contact applications, the LED lumen maintenance expectation for each lumen package is:

- K: L<sub>80</sub> (12k) 71,000 hrs
- G: L<sub>80</sub> (12k) 68,000 hrs
- E: L<sub>80</sub> (12k) 54,000 hrs

### Mounting

Mounting brackets on housing sides support T-Grid installation. 1/16" diameter aircraft cable with self-locking tamper-resistant, miniature cable gripper provides vertical adjustment for drywall. Aircraft cable, crimp and gripper independently tested to meet stringent safety requirements.

### Joints

Self-aligning joining system with hands-free pre-joining wire access.

### Electrical

Factory pre-wired to section ends with quick-wire connectors.

### Approvals

Certified to UL, CSA and IES standards. Insulation Contact (IC) rated.

### Finish

Extruded aluminum trim and die-cast endplates coated with electrostatically applied and thermally cured polyester powder coat paint finish.

### Environment

Rated for dry or damp locations in operating ambient temperatures 0-40°C (32-104°F).

Due to continuing product improvements, Philips Ledalite reserves the right to change the specifications without notice.



© 2014 Koninklijke Philips N.V. (Royal Philips). All rights reserved.  
Specifications are subject to change without notice.  
[www.philips.com/luminaires](http://www.philips.com/luminaires)

39S1LBEQ.pdf 03.14 page 4 of 4

Philips Lighting Company  
200 Franklin Square Drive  
Somerset, NJ 08873  
Phone: 855-486-2216